

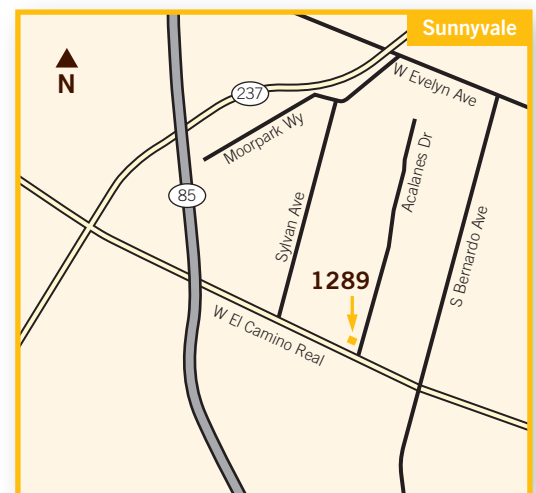

±9,000 sq ft retail space for lease

1289 W. El Camino Real, Sunnyvale

- 121' frontage on El Camino Real
- 100% HVAC high-bay showroom improvements
- Grade level loading
- 4/1000 parking
- Building and pole signage available
- Non-signalized left turn lane into property from Southbound El Camino Real
- New and used vehicle sales use permit in place
- Zoned C2



Geordie McKee · Dave Conklin · Leonard Ely III 650.321.3040

Lic. 01257296

Lic. 01036562

Lic. 01412521

±9,000 sq ft retail space for lease

1289 W. El Camino Real, Sunnyvale

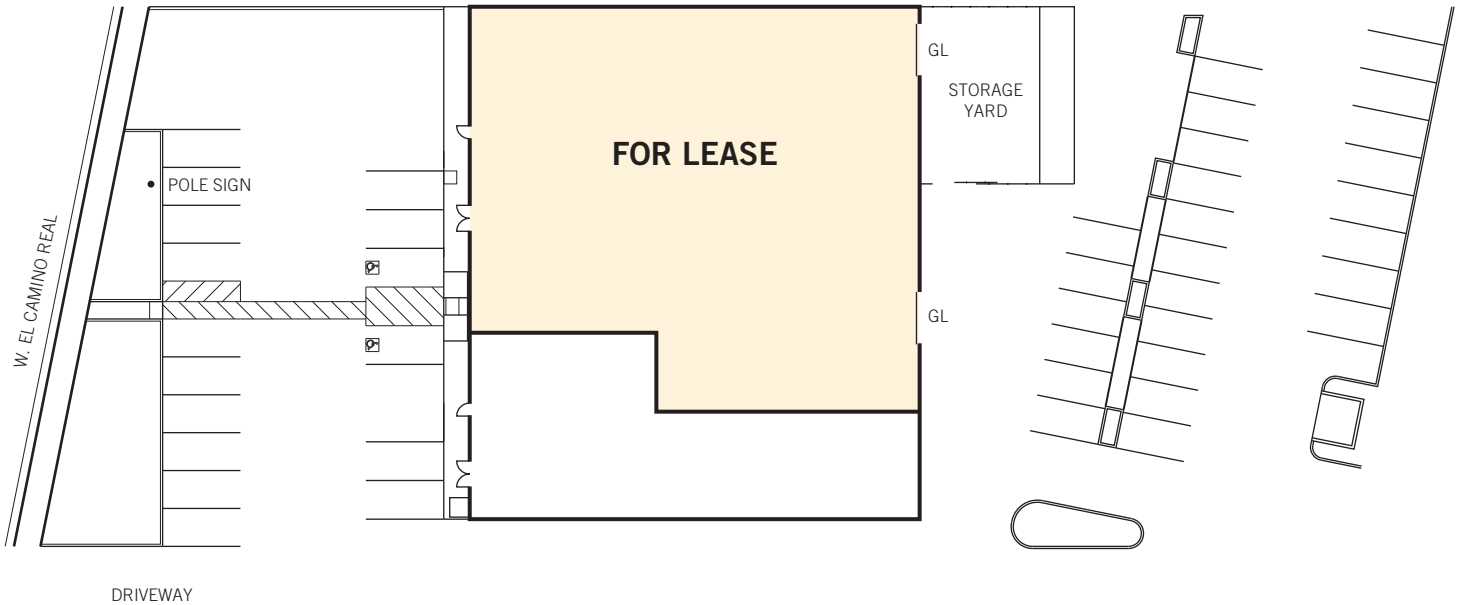

Floor plans may not be to scale. The information contained herein has been obtained from sources we deem reliable. We have no reason to doubt its accuracy, but we do not guarantee it. All information should be verified prior to lease.

Geordie McKee · Dave Conklin · Leonard Ely III 650.321.3040
Lic. 01257296 Lic. 01036562 Lic. 01412521